

WINDOW UNIT ASSEMBLY DETAIL:

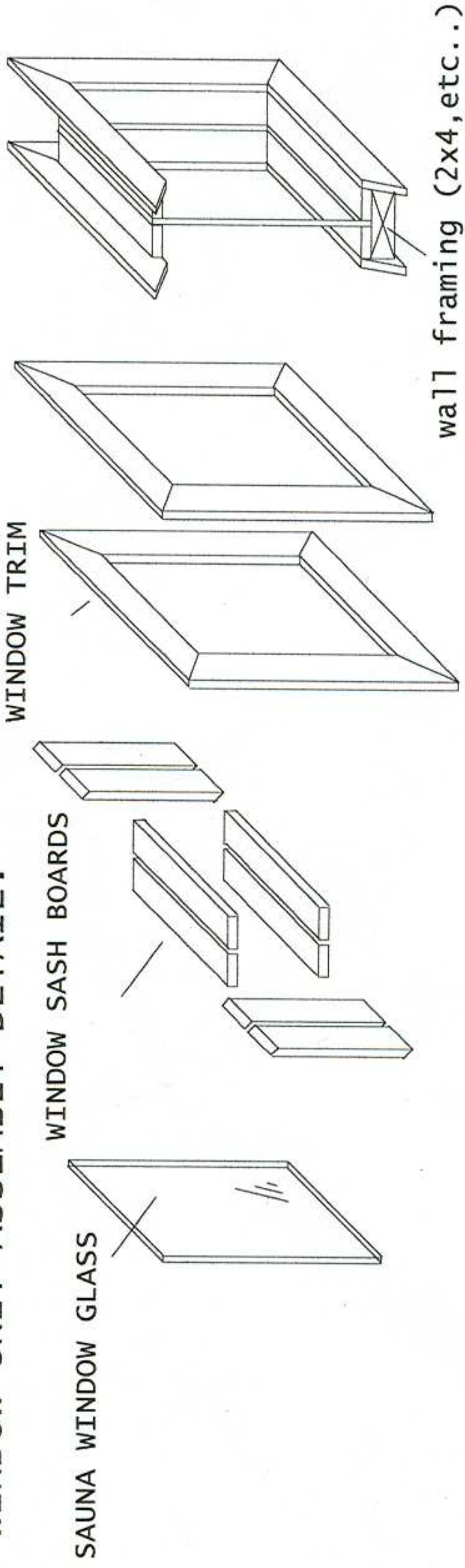

- Window Installation:
- Step #1. - Frame window opening 1/4" larger than glass size.
 - Step #2. - Install inner sash boards around opening flush to the inside cedar edge. (see diagram)
 - Step #3. - Caulk edge of sash with silicone prior to glass installation.
 - Step #4. - Place glass in opening against the sash.
 - Step #5. - Install outer sash boards flush with the exterior wall surface.
 - Step #6. - Install interior and exterior window trim.

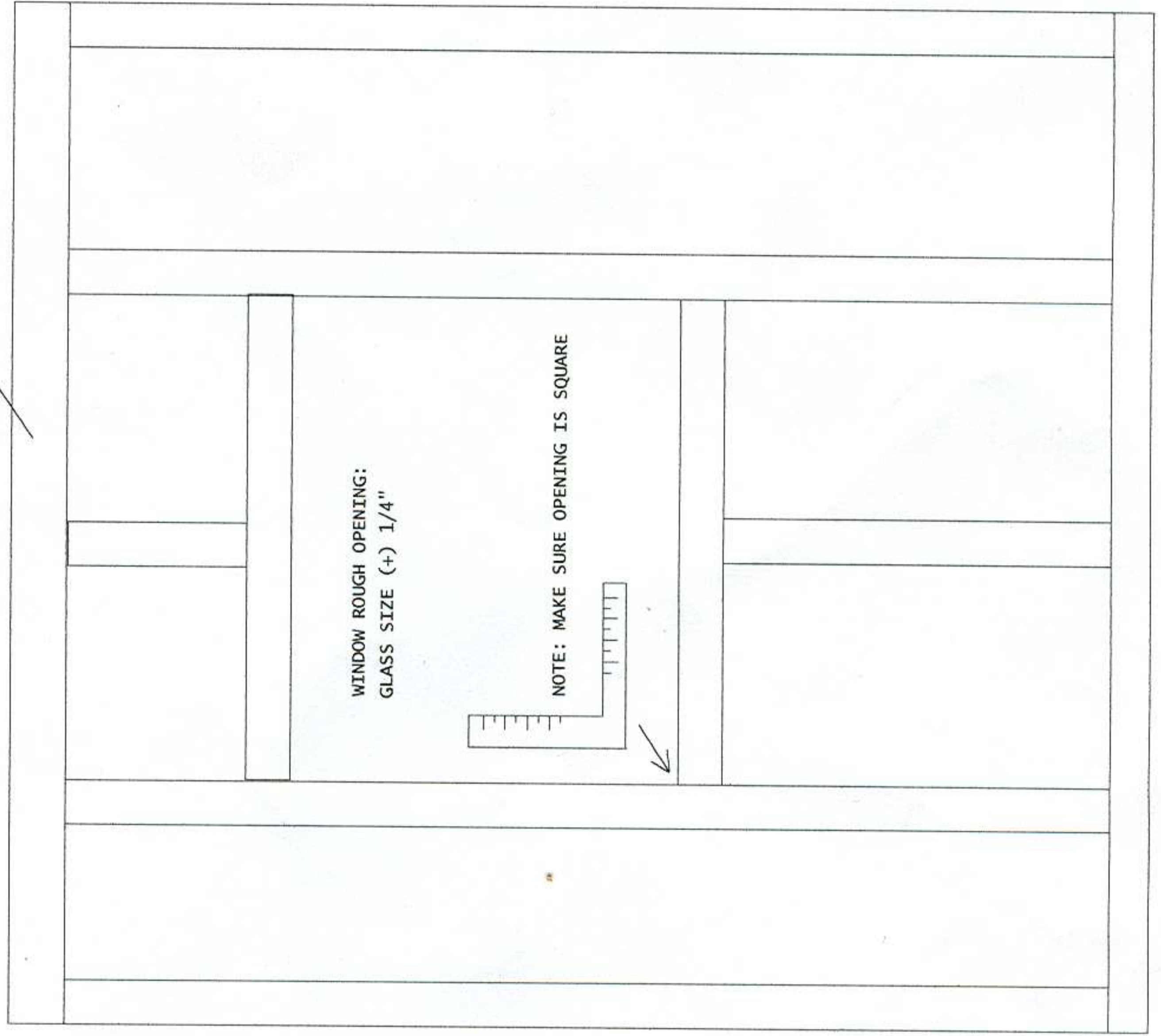
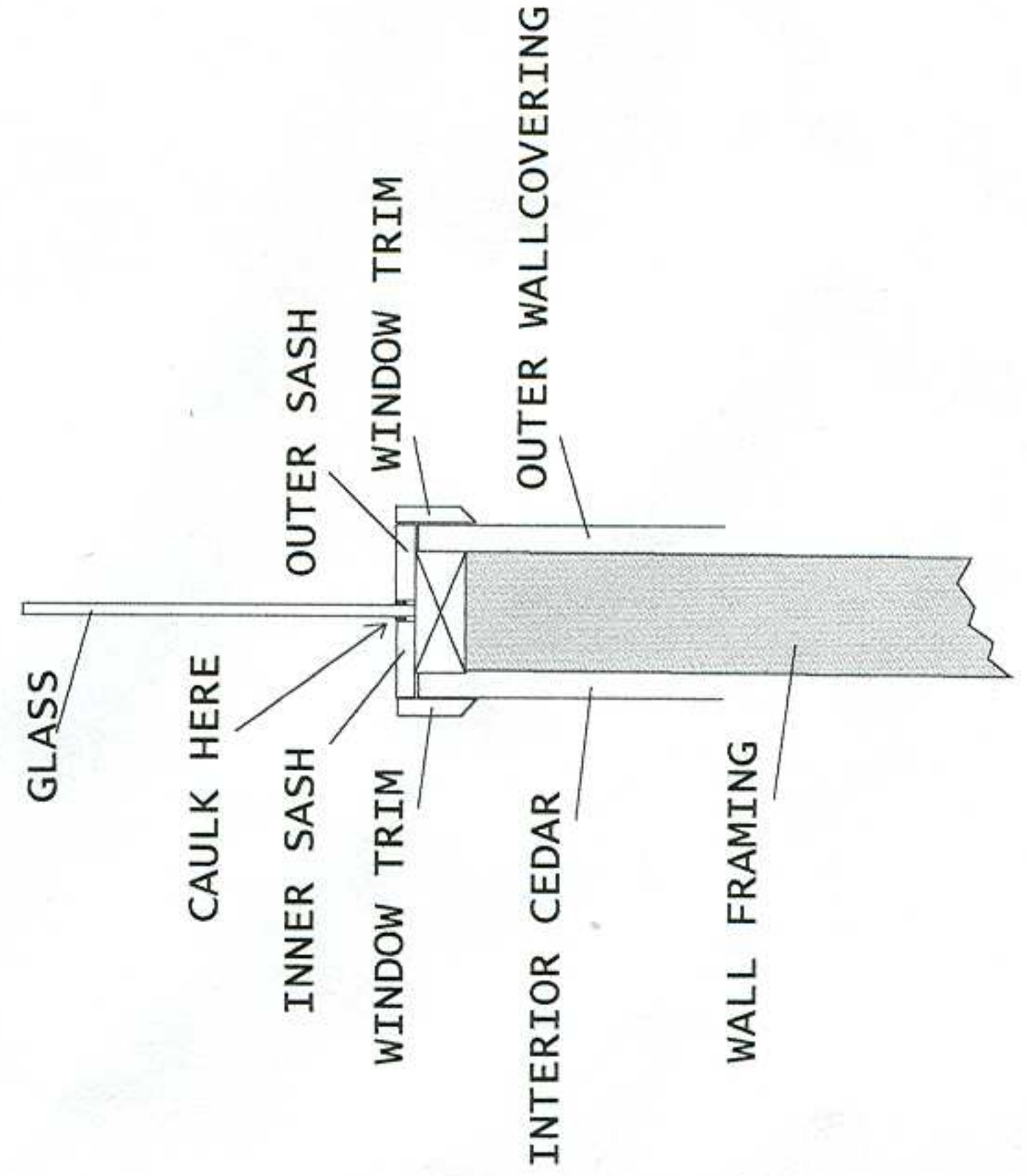

NOTE: MAKE SURE OPENING IS SQUARE

WINDOW ROUGH OPENING:
GLASS SIZE (+) 1/4"

wall framing (2x4, etc..)